

CIVIL AVIATION BOARD

DEPARTMENT OF DEFENCE

AUSTRALIA

NOTICE TO AIRMEN

NO. 69/1936.

(CANCELS No. 27/1931).

NHILL, VIC.

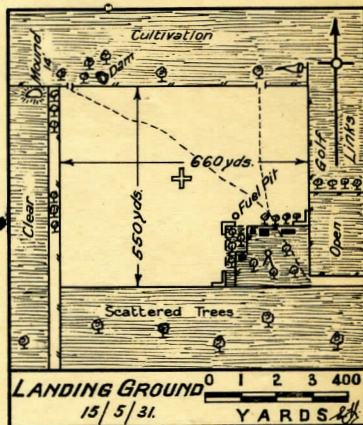
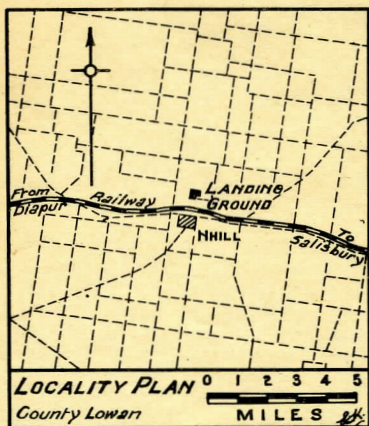

CLASS OF GROUND: Emergency Landing Ground.

PROPRIETORS: Civil Aviation Board, Melbourne.

POSITION: About $\frac{1}{2}$ mile north of Nhill railway station;Lat. $36^{\circ} 19' S$. Long. $141^{\circ} 48' E$.MAGNETIC VARIATION: About $6\frac{1}{2}^{\circ} E$.

LANDMARKS: Golf course on eastern boundary; house and windmill at south-east corner.

MARKINGS: White cross, wind indicator and corner marks.

SURFACE ETC.: Undulating grass land with general fall to west.

DIMENSIONS: N - S 550 yards, E - W 660 yards.

HEIGHT ABOVE SEA LEVEL: About 430 feet.

APPROACHES: Generally open with few trees along road on western boundary.

SURROUNDING COUNTRY: Cultivated, suitable for forced landing.

PETROL AND OIL: At landing ground.

WATER SUPPLY: At landing ground.

WORKSHOPS: Nhill, 1 mile south.

HANGAR ACCOMMODATION: Nil.

TELEPHONE: House at south-east corner.

TELEGRAPH: Nhill.

NEAREST TOWN & RAILWAY STATION: Nhill.

CHARGES: Nil at present.

REMARKS: Tracks across ground are liable to become washed out in wet weather; landing ground is used for grazing. Strip-map No. 5.

S. H. Crawford

SECRETARY, CIVIL AVIATION BOARD.